

OPERATION

Fitting The Planer

CHECK that the Planer is the correct model and type to fit the Earth Drill Unit.

ENSURE that the Planer connections are clean before fitting.

USE suitably rated lifting equipment if required (see data plate for weight).

Position the Planer in the vertical work position and support it so that it cannot fall over. Position the Earth Drill over the Planer and align the pin holes. Lower the Earth Drill Unit onto the Planer and locate the Drive Pin. Secure the Drive Pin with Linch Pin.

Engaging Blades

The pilot engages with the top surface of the tree stump, drawing the tool down allowing the blades to engage with a clean horizontal cut. If the blades fail to engage, move the planer forwards and backwards until blades engage, then return tool to upright position.

Cutting Sequence

When removing large stumps, the planer can be repositioned to overlap each hole in the sequence shown. Repeat until the entire stump is removed.

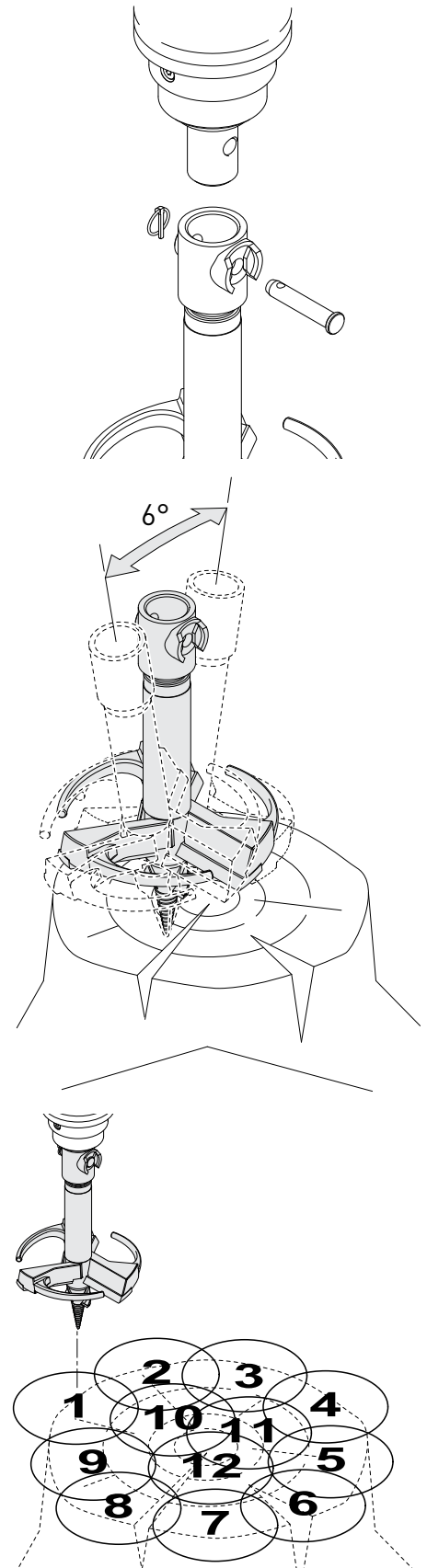

MAINTENANCE

Removing & Sharpening Blades

In the unlikely event that the blades become damaged, they can be individually removed and sharpened.

This process also applies when the blade loses its cutting edge due to wear.

Remove blades from planer by removing screws from underside of blades.

To sharpen the blade, first follow the removal process. Using a bench grinder fitted with a "Green" Silicone Carbide, make several small passes against the cutting face ensuring that the cutting edge angle is maintained at 50 degrees.

Blade Life

After repeated sharpening, the blade will come to the end of its useful life. The diagram details acceptable levels of wear.

Pilot Replacement

Remove pilot using an 8mm hex key.

To separate the pilot from the pilot head, use a punch to drive the retaining pin out of the pilot. The pilot can then be withdrawn.

To install new pilot, reverse above instructions.

ENSURE PILOT IS TIGHT PRIOR TO USE.

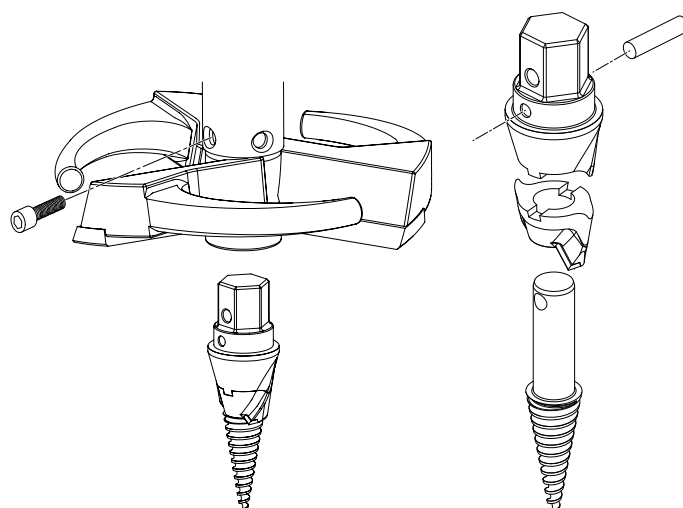
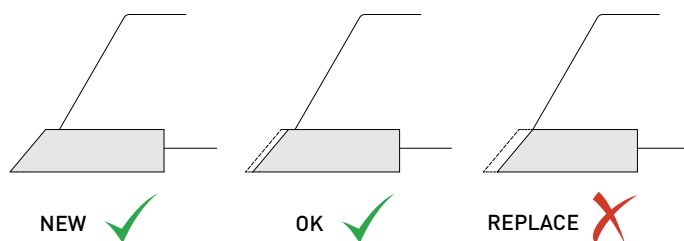
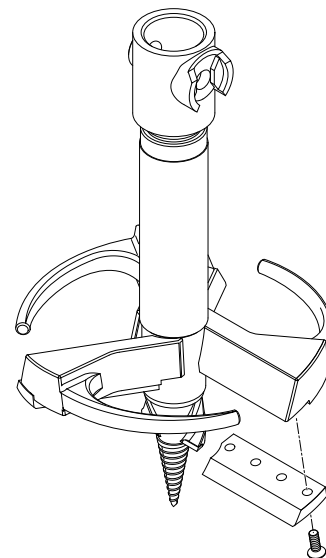



STUMP PLANER OPERATION & MAINTENANCE

WARRANTY STATEMENT

Auger Torque provide a LIFETIME parts replacement warranty on the dislodgement of the Earth Drill shaft and any failure of the Shock Lock system to prevent loss of teeth under normal operating conditions.

All Auger Torque products are warranted to be free from defects in materials or workmanship for the periods summarised below:

- Planetary Gearbox Components - 72 Months
- Hydraulic Motors - 36 Months
- All Other Parts / Products - 12 Months

The warranty periods will commence from Date of Sale by an authorised Auger Torque Dealer. Evidence of the date of sale may be required and for Planetary and Hydraulic Motor warranties to be valid the product must be registered with Auger Torque within 4 weeks of the date of sale. Extended Warranty (> 12 months) Products can be registered by returning the Registration Card or completing the form on page 8. This warranty is not transferable beyond the initial purchaser of the product.

A warranty claim should be reported to the Auger Torque Dealer who supplied the unit. The Dealer, with the technical backup of Auger Torque, will make an initial assessment.

The customer is responsible for returning the product for warranty inspection to the original supplying dealer's facility. Parts should not be delivered without the prior agreement of the dealer or Auger Torque.

During the warranty period Auger Torque, at its option, will repair or replace any parts free of charge determined as defective by Auger Torque. Such repairs will be undertaken by Auger Torque or its nominated representative at an Auger Torque facility or a location deemed suitable by Auger Torque. Auger Torque are not liable for any associated costs relating to a warranty failure.

Parts repaired or replaced by Auger Torque are then covered by this warranty for the remainder of the original warranty as if such parts were original parts.

Products or parts which, as determined by Auger Torques examination, show wear from normal use, have been improperly operated, damaged by accident or negligence, altered or modified are not considered defective and are not covered by this warranty.

This warranty is void if any attempt is made to make field repairs unless these have been pre-approved in writing by Auger Torque.

This warranty is void if the products are not serviced in-line with the instructions in the Operators Manual. Particular care should be taken to perform regular oil changes in gearboxes.

This warranty is exclusive and in-lieu of any other expressed warranties. There are no warranties of merchantability or fitness for a particular purpose. Auger Torque shall not be liable for any consequential, incidental or punitive damages, losses or expenses, including those resulting from or caused by any defects.

As you would expect from Auger Torque, with our extensive experience and product reliability we'll always go the extra mile to keep you working.



YOUR DEALER IS

Auger Torque Europe Ltd

Hazleton
Cheltenham
GL54 4DX
England
Tel: +44 (0) 1451 861652
Fax: +44 (0) 1451 861660
Email: sales@augertorque.com

Auger Torque Australia Pty Ltd

122 Boundary Rd
Rocklea
Queensland 4106
Australia
Tel: +61 (0) 7 3274 2077
Fax: +61 (0) 7 3274 5077
Email: sales@augertorque.com.au

Auger Torque USA LLC

2640 Jason Industrial Parkway
Winston, GA 30187
USA
Tel: (+1) 844 287 6300
Fax: (+1) 770 947 9916
Email: sales@augertorqueusa.com

www.augertorque.com



Products and specifications subject to change without prior notice.
Some products may not be available in your country or region.

AUGER TORQUE, SHOCK LOCK™, NDS™ and the AUGER TORQUE LOGO are trademarks of Auger Torque Europe Ltd © 2021 Auger Torque Europe Ltd. All Rights Reserved.