

# MIXER BOWL QUICK START GUIDE



This Auger Torque quick start guide will enable you to get your new product up and running in no time. The complete operators manual is available on the Auger Torque website. To download a copy in pdf format, simply scan the QR code or visit [www.augertorque.com](http://www.augertorque.com).

99-95513702 - ISSUE 1-0

ENGLISH

For warranty purposes this product **MUST** be registered with Auger Torque within 14 days of purchase by the end user.



PARTS CHECKLIST		
Item	Description	Quantity
1	Bowl Top	1
2	Gasket	1
3	Bowl Base	1
4	Hub	1
5	Paddle	2
6	Adapter Plate	1
7	Strengtheners Plate	1
8	Bolt M8 x 25mm	14
9	Spring Washer M8	10
10	Nyloc Nut M8	24
11	Set Screw M8 x 30	10
12	Set Screw M8 x 35	8
13	Set Screw M8 x 40	2
14	Plain Washer M8	54
15	Penny Washer M8	4

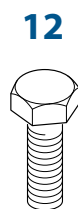
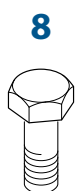
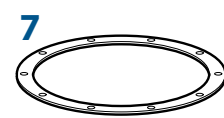
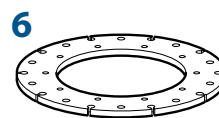
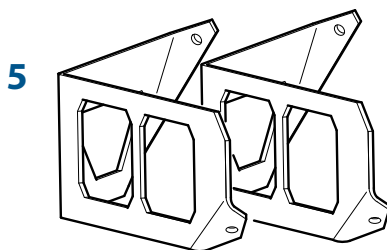
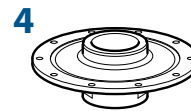
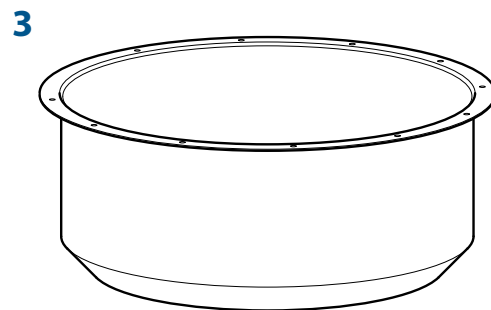
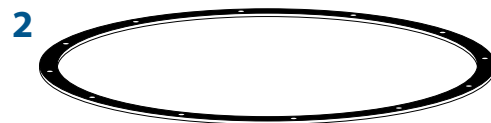
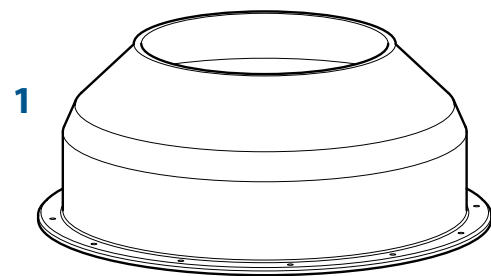

## ASSEMBLY INSTRUCTIONS

With the bowl base inverted, insert 8 screws, washers and nyloc nuts up through the bowl base leaving 2 holes as shown.

With the bowl top inverted, insert 12 screws with washers up through the holes in the rim of the bowl top and the gasket. The holes in the gasket are a tight fit on the screws and will prevent them from falling out.

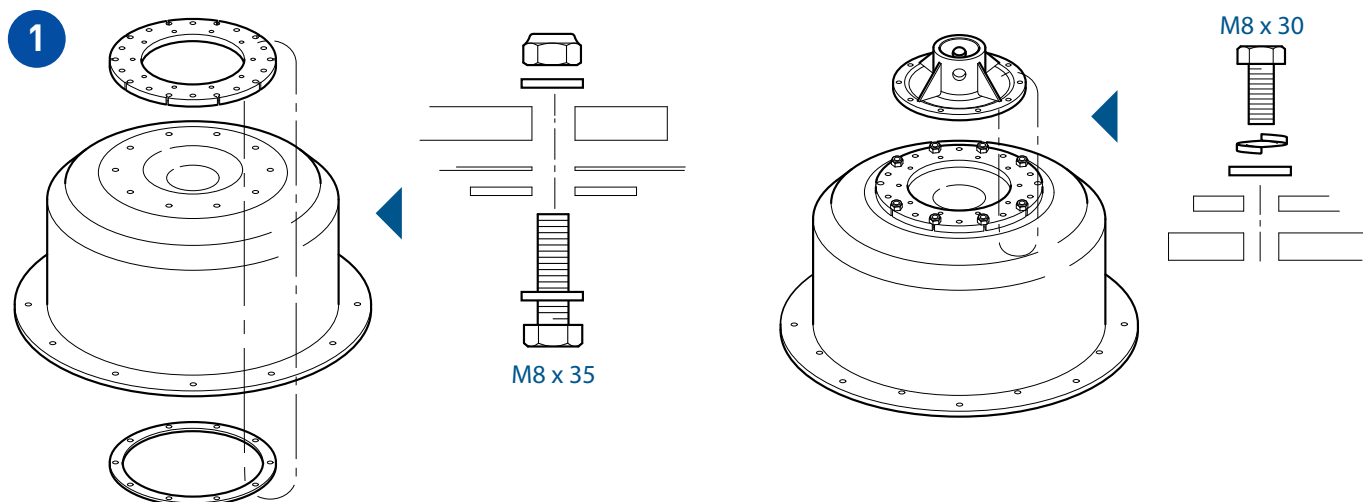

Turn the bowl top over and lower it on to the bowl base. Holes for mounting the mixer paddles are located in the hood top and the drive hub, where 2 bolts have been left out. Use Detail A as a guide for the arrangement of the mounting holes when aligning the screws to fix the bowl top together.

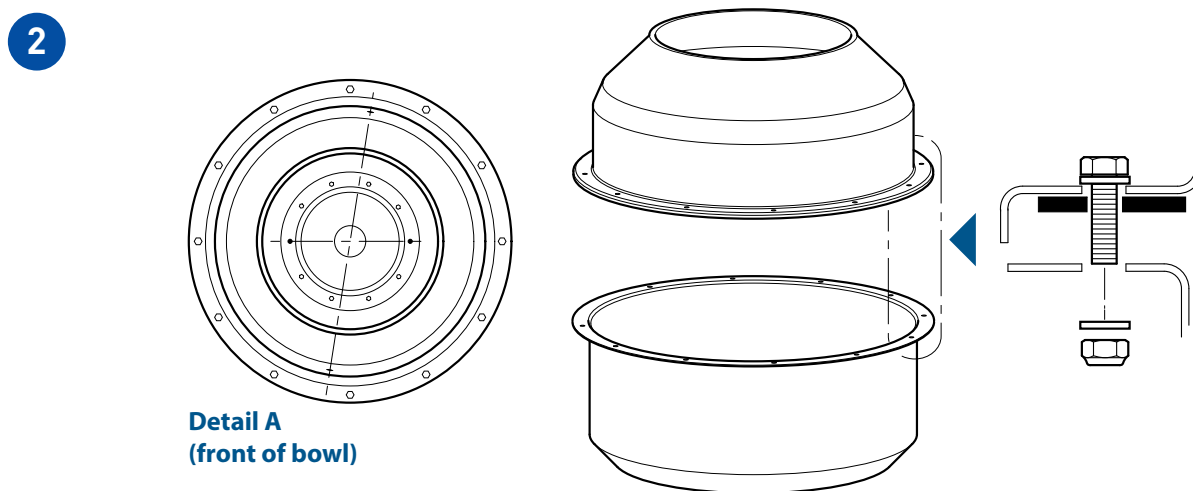

Attach the paddles as shown in Details B, C & D.

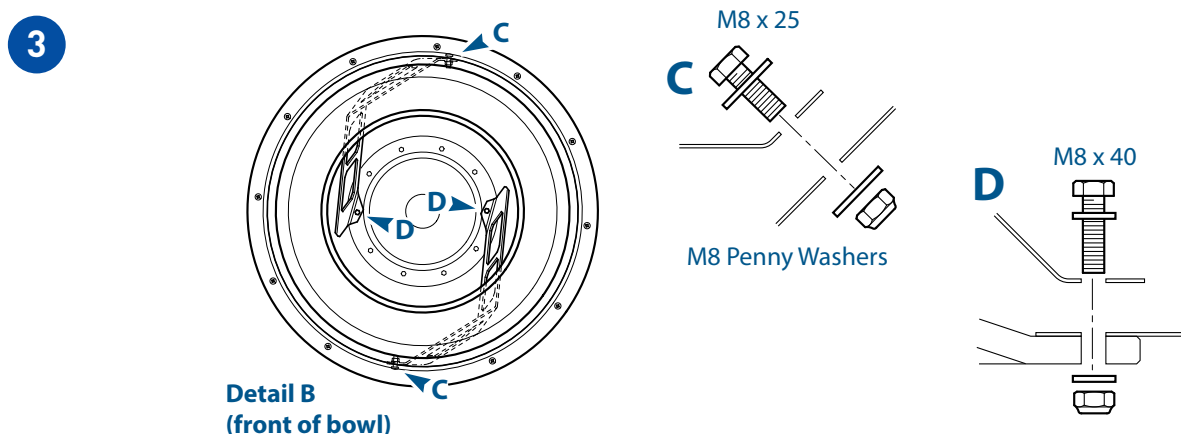

# MOUNTING - MIXER HITCH

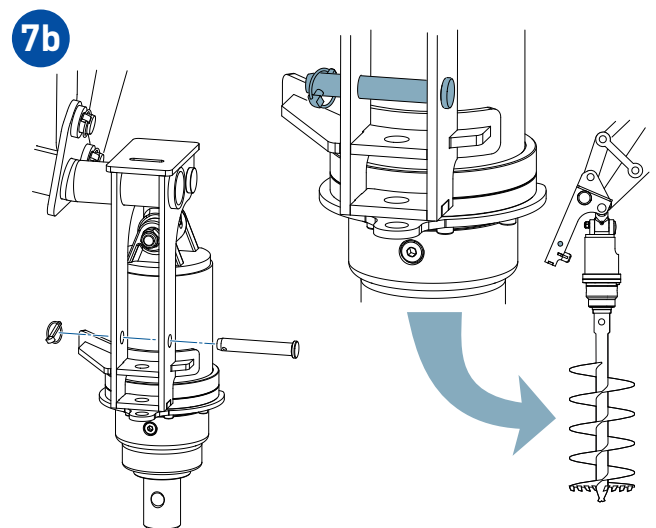
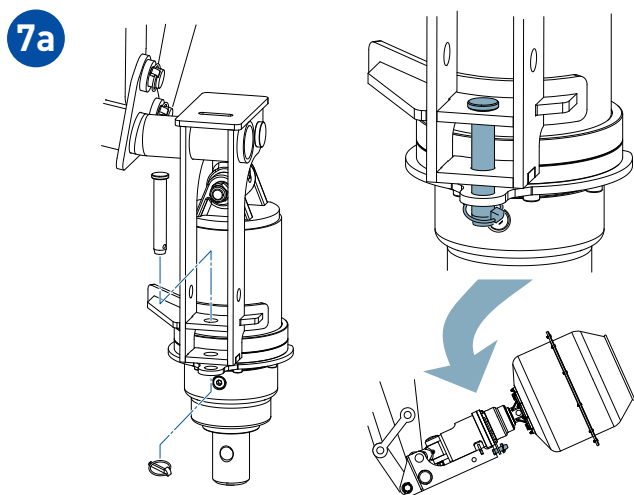
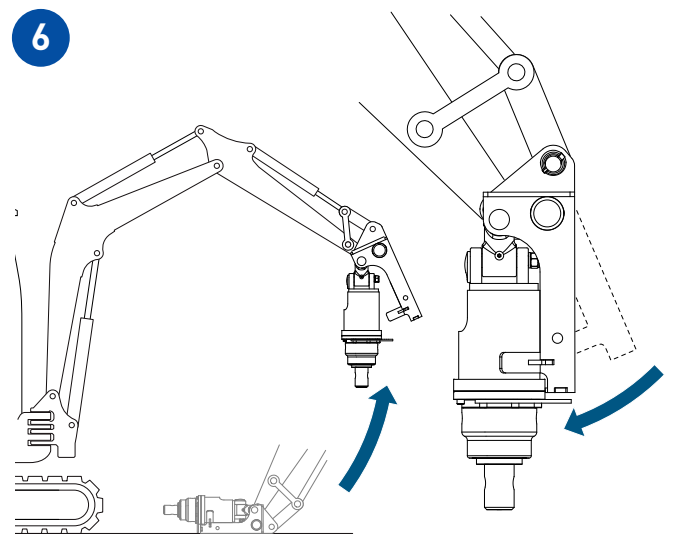
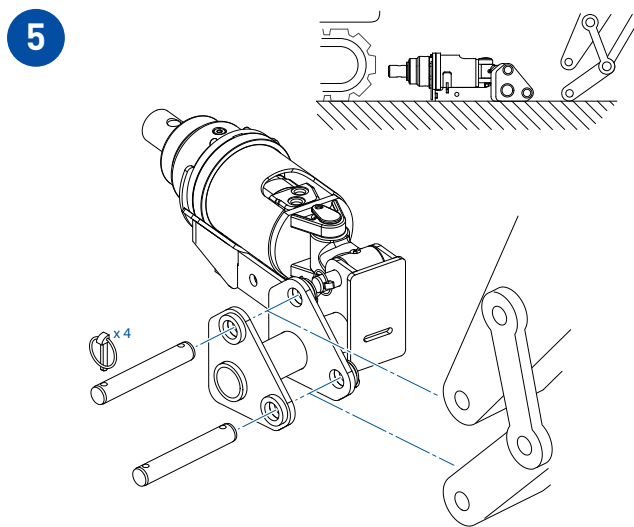
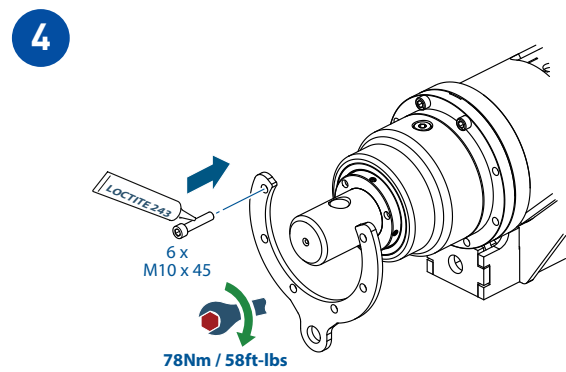
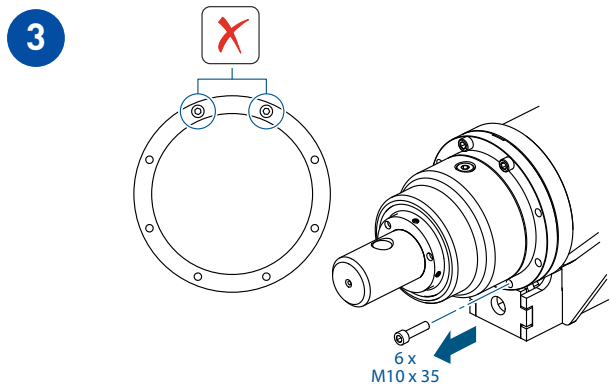
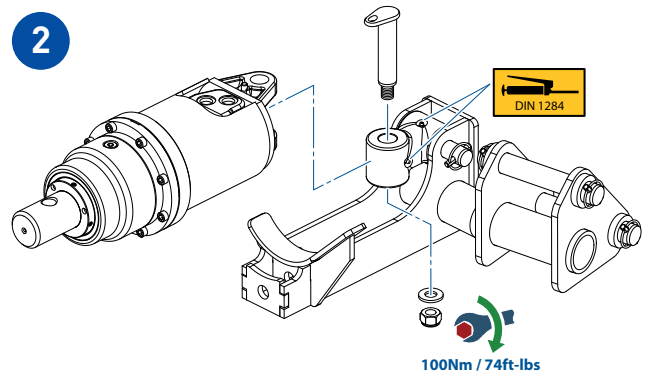
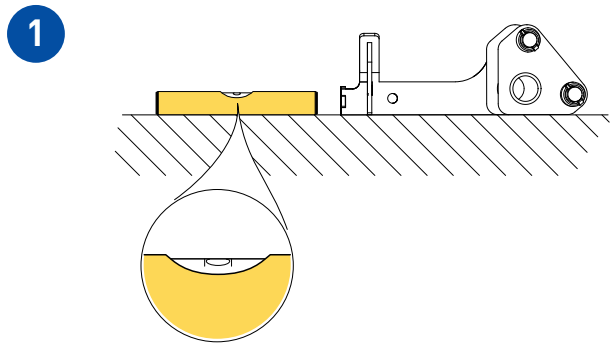

# MOUNTING - SIDESHIFT FRAME

1

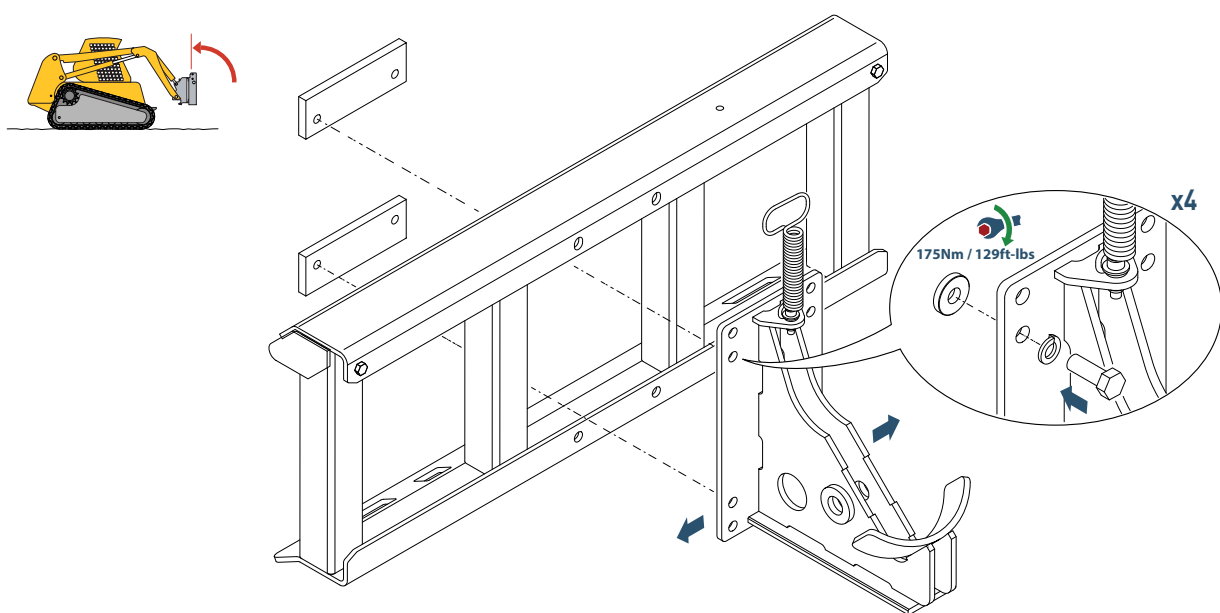

2

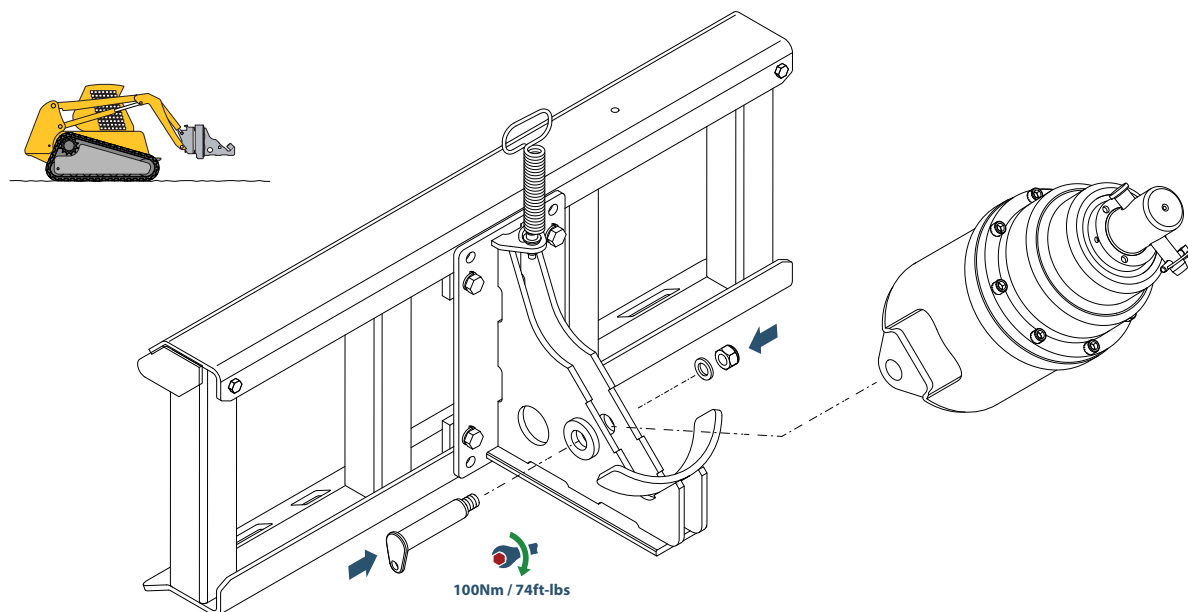

3

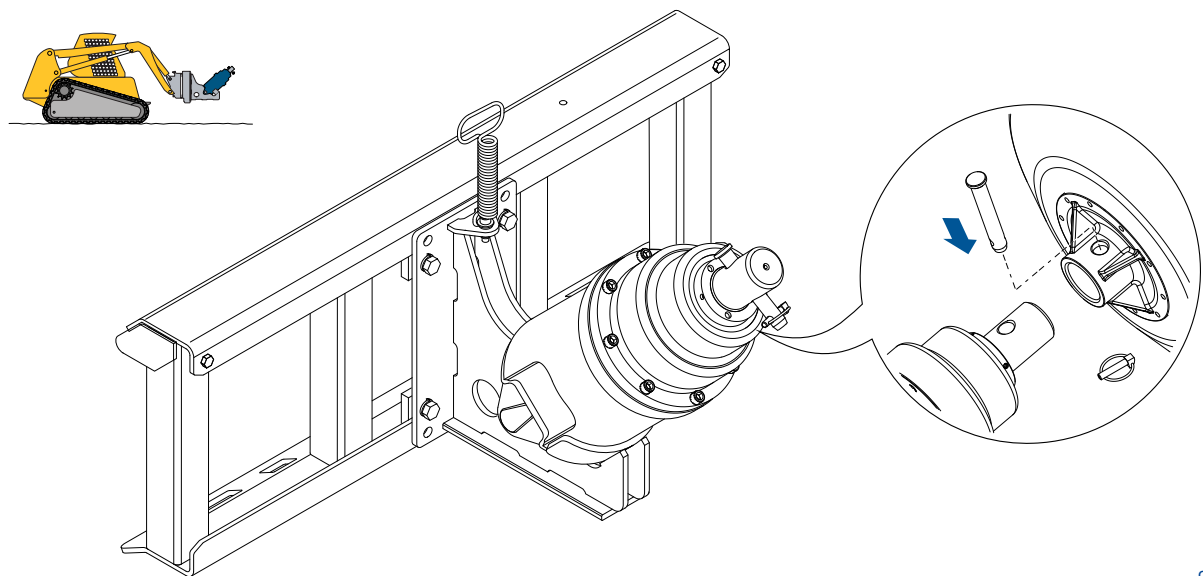

06-05-2021